

From the desk of Amy Ho

CIMB HUB @ Jalan Sultan Ismail, Kuala Lumpur

from **MYR 6.00** per sq. ft.

Introducing CIMB Hub: Kuala Lumpur's 22-Storey Office Jewel in the Heart of the Golden Triangle

Situated on Jalan Sultan Ismail, CIMB Hub—previously known as Kenanga International—presents over 140,000 sq. ft. of prime office space across its 22 towering floors and an additional 3 ½ level podium annex.

Strategically positioned, CIMB Hub boasts dual frontage access. This ensures seamless connectivity to iconic destinations like KLCC and Pavilion KL through a sheltered walkway. Additionally, three pivotal LRT/MRT stations are conveniently accessible. Jalan Sultan Ismail features a row of bus stops just a brief 5-minute stroll from the building. Furthermore, the Raja Chulan Monorail, Bukit Bintang MRT, and KLCC LRT Station are all within a comfortable walking distance. For those driving, major thoroughfares such as the AKLEH Expressway, Maju Expressway (MEX), and Lebuhraya Sultan Iskandar provide easy entry.

Amenities at this contemporary office complex include 634 parking spaces, advanced turnstile card access, centralized air-conditioning, an inviting lobby, a cafeteria, and a surau.

Please contact Amy Ho @ +6012-3321188 to schedule a viewing appointment today!



GROUND FLOOR & MEZZANINE FLOOR | F&B and RETAIL SPACES

from **MYR 6.00** per sq. ft.

AVAILABLE SPACE		SIZE sq. ft.	FURNISHING	RENTAL RATE	RENTAL, MYR	REMARKS
PODIUM BLOCK						
A	Ground Floor	5,387	Bare unit	MYR 10.00	MYR 53,870	RETAIL BANKING HALL F & B SHOWROOM
	Mezzanine Floor	4,596	Bare unit	MYR 6.00	MYR 27,576	
TOWER BLOCK						
B	Ground Floor	143	Bare unit	Flat Rate	MYR 2,800	F & B Outlet
C	Ground Floor	1,393	Bare unit	MYR 8.00	MYR 11,144	Clinics; Dentist; Logistic Services
D	Mezzanine Floor	8,474	Bare unit	MYR 6.00	MYR 50,844	Ideal for Gym Can be subdivided into 3

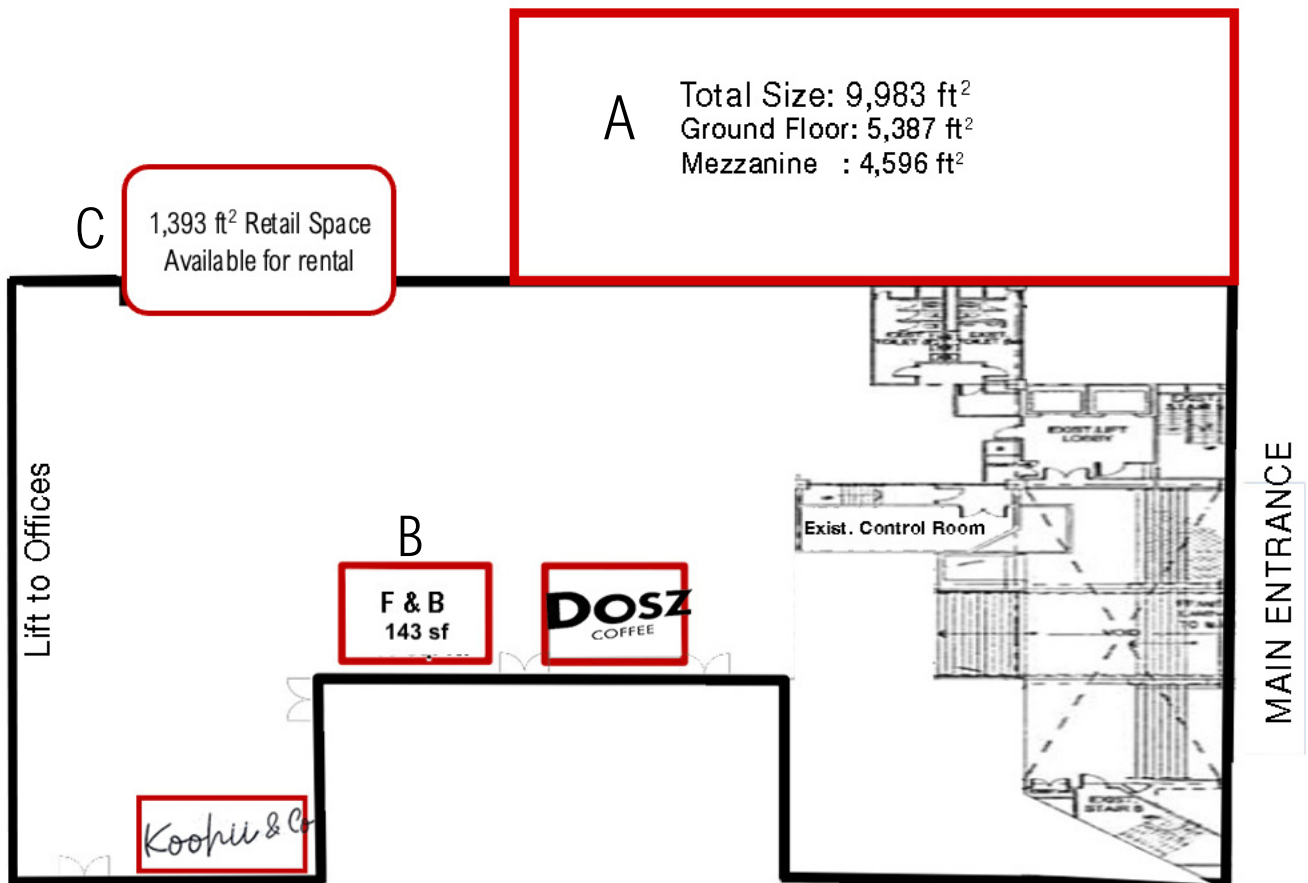

A. GROUND & MEZZANINE FLOOR RETAIL SPACE | Total Size 9,983 ft² Rental MYR 81,446/month

This unit faces Jalan Sultan Ismail and sits to the right of the main entrance. It's perfect for a banking hall, upscale F&B outlet, showroom, or exclusive club.



From the desk of Amy Ho

B. GROUND FLOOR RETAIL KIOSK | Size: 143 ft²



RETAIL KIOSK LOCATION

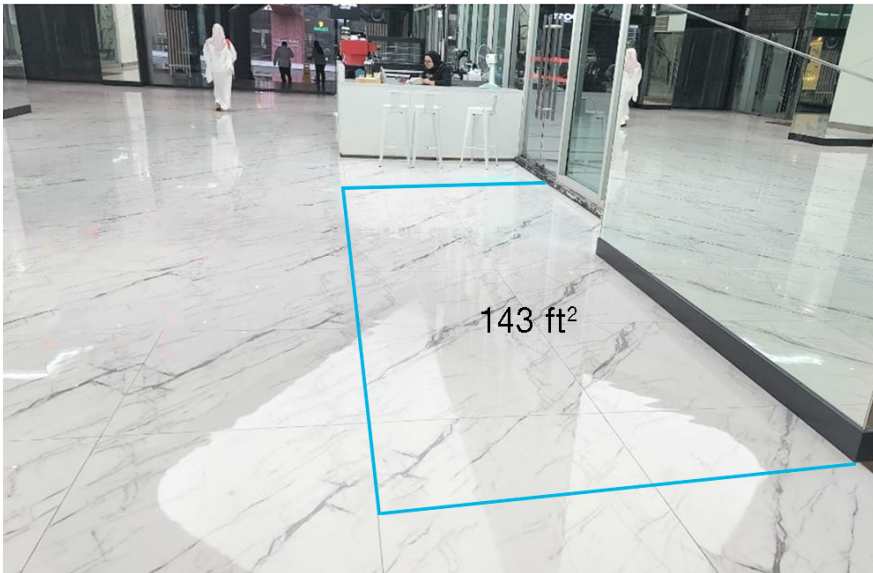

CAFÉ @ THE LOBBY

C. GROUND FLOOR TOWER BLOCK | 1,393 ft² Rental: MYR 11,144/month

This unit faces the lift on the Ground Floor Lobby area. Ideal for Clinics, Convenient Store, Logistic Company.

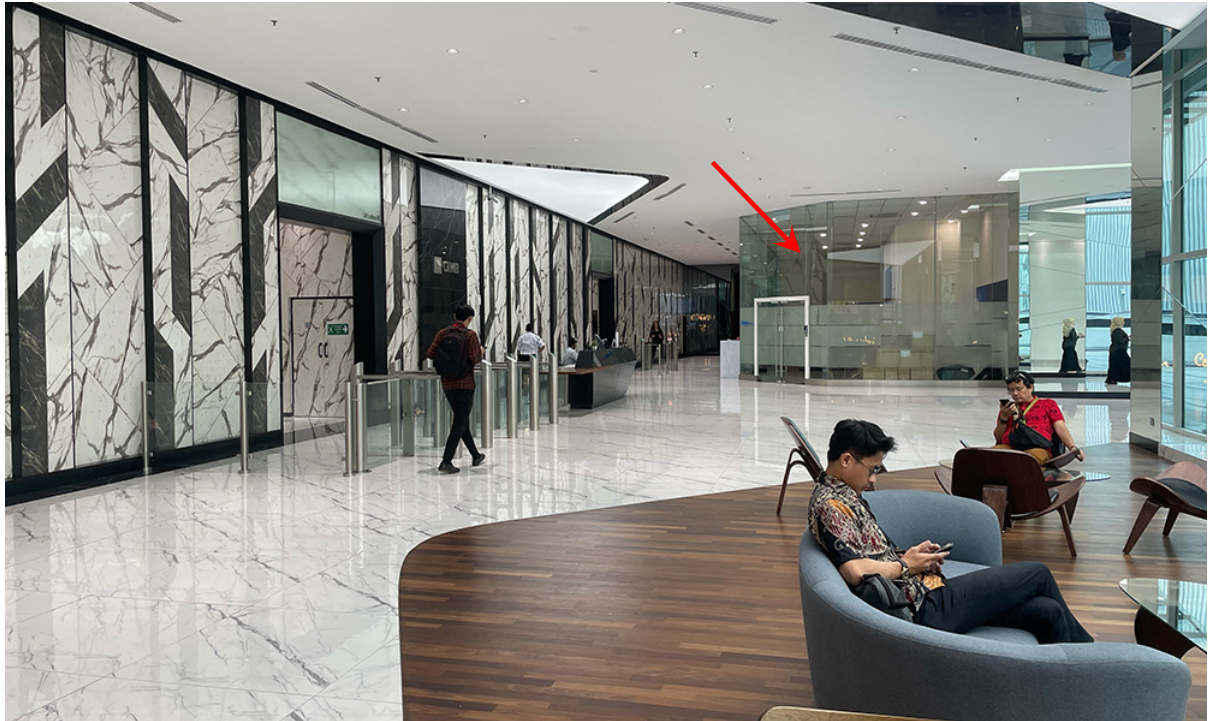

FLOOR PLAN

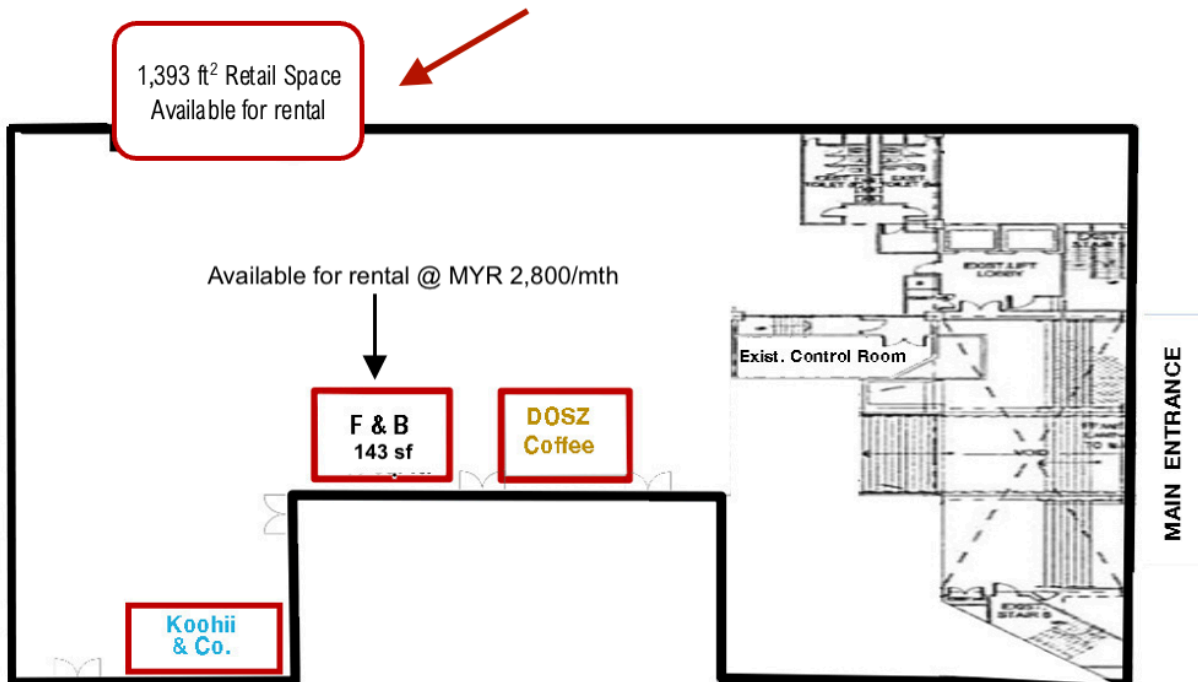

From the desk of Amy Ho

- D. MEZZANINE FLOOR RETAIL SPACE | IDEAL FOR GYMNASIUM
This unit can be sub-divided into 3 smaller units.

View of Jalan Perak



View of Jalan Sultan Ismail

