

From the desk of Amy Ho

FOR RENT: GROUND FLOOR LOBBY RETAIL SPACE @ CIMB HUB, JALAN SULTAN ISMAIL

Rental : MYR 11,144 (MYR 8.00/ft².)

Size : 1,393 ft²

Remarks : With an occupancy rate of 70%, CIMB Hub houses over 2,500 staff members, providing excellent visibility and foot traffic for businesses.

Introducing CIMB Hub: A 22-story landmark offering 360,000 ft² of premium office space and a 3½-level podium annex. Strategically located in Kuala Lumpur's Golden Triangle, the building is within walking distance of the Raja Chulan Monorail, Bukit Bintang MRT, and KLCC LRT stations. Enjoy easy access to KLCC and Pavilion KL via a sheltered walkway. The available unit is conveniently located to the right of the main entrance, directly facing the Reception Counter.

Amenities:

- 634 parking spaces
- Turnstile card access
- Centralized air-conditioning
- Welcoming lobby, cafeteria, coffee kiosks, and surau

Contact Amy Ho @ +6012-3321188 to schedule a viewing appointment today!

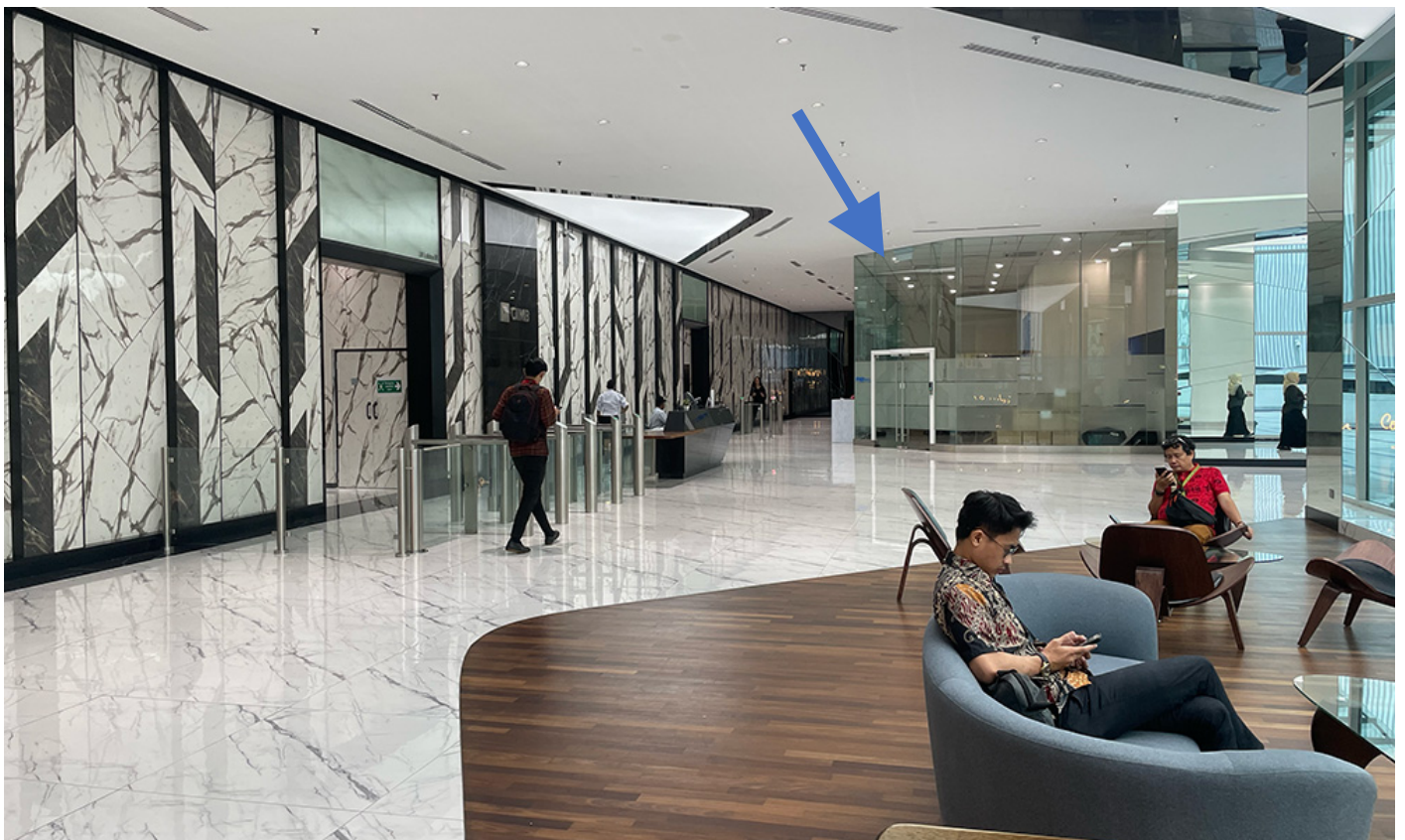

From the desk of Amy Ho

FLOOR PLAN

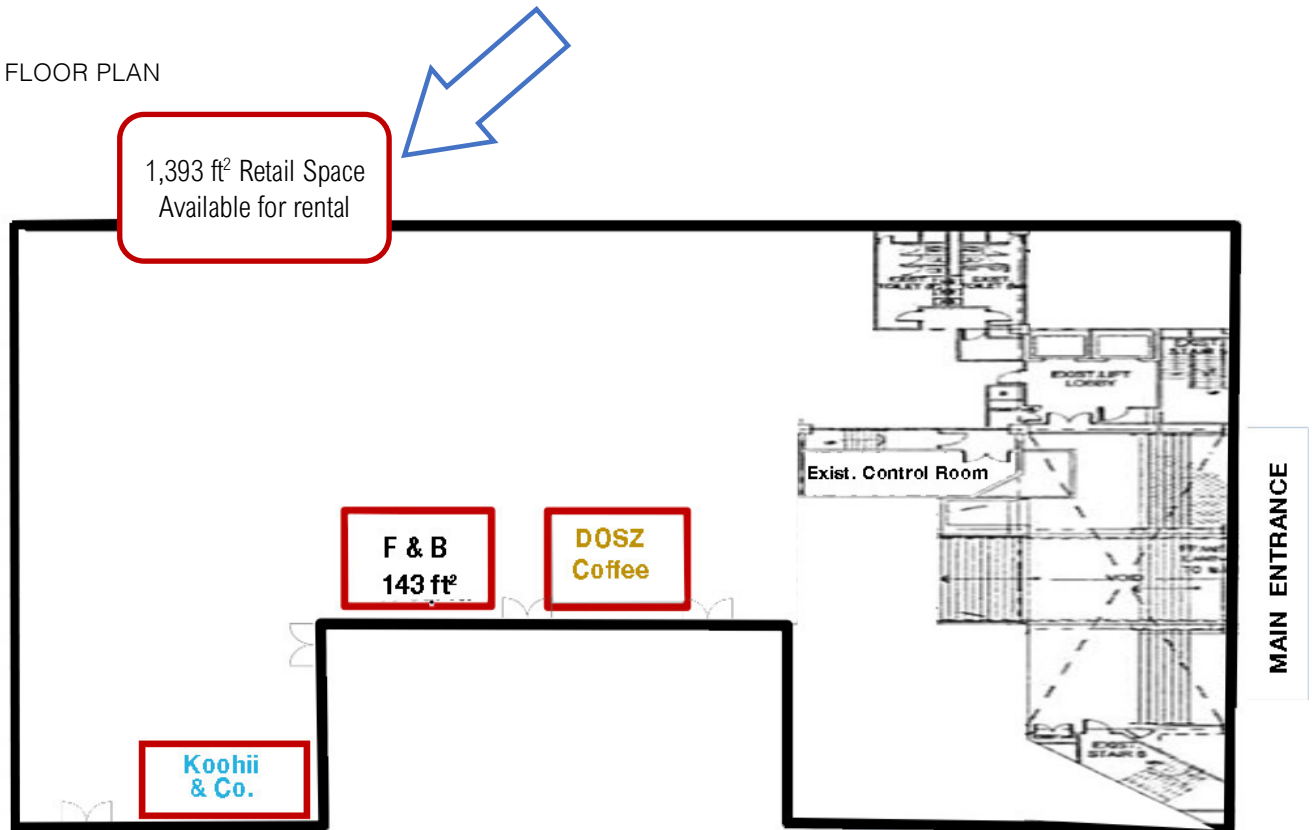

CAFÉ @ THE LOBBY



TAKE-AWAY COFFEE @ THE LOBBY